

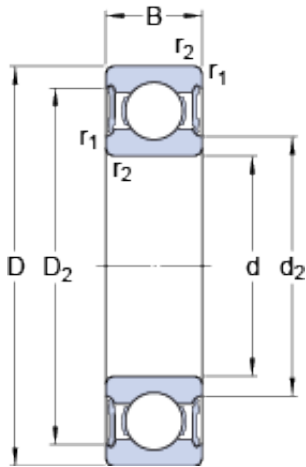

## China abec 5 Bearing Supplier



61806-2RS1 Bearing 2D drawings and 3D CAD models

Deep Groove Ball Bearing 61806-2RS1 SKF Ball Bearing 61806 2RS1 SKF Bearing 618062RS1 SKF 6806

Bearing No. 61806-2RS1

Size	42x30x16 mm
Bore Diameter	42 mm
Outer Diameter	30 mm
Width	16 mm
d	30 mm
D	42 mm
B	16 mm
d <sub>2</sub>	32.6 mm
D <sub>2</sub>	39.4 mm
r <sub>1,2</sub> - min.	0.6 mm
d <sub>a</sub> - min.	32 mm
d <sub>a</sub> - max.	32.5 mm
D <sub>a</sub> - max.	40 mm
r <sub>a</sub> - max.	0.3 mm
Basic dynamic load rating - C	4.5 kN
Basic static load rating - C <sub>0</sub>	2.9 kN
Fatigue load limit - P <sub>u</sub>	0.146 kN
Limiting speed	9500 r/min
Calculation factor - k <sub>r</sub>	0.015
Calculation factor - f <sub>0</sub>	13.9
Category	Single Row Ball Bearings
Inventory	0.0
Manufacturer Name	SKF



## China abec 5 Bearing Supplier

Minimum Buy Quantity	N/A
Weight / Kilogram	0.027
EAN	7316577095244
Product Group	B00308
Enclosure	2 Seals
Precision Class	ABEC 1   ISO P0
Maximum Capacity / Filling Slot	No
Rolling Element	Ball Bearing
Snap Ring	No
Internal Special Features	No
Cage Material	Steel
Enclosure Type	Contact Seal
Internal Clearance	C0-Medium
Inch - Metric	Metric
Long Description	30MM Bore; 42MM Outside Diameter; 7MM Outer Race Diameter; 2 Seals; Ball Bearing; ABEC 1   ISO P0; No Filling Slot; No Snap Ring; No Internal Special Features
Category	Single Row Ball Bearing
UNSPSC	31171504
Harmonized Tariff Code	8482.10.50.68
Noun	Bearing
Keyword String	Ball
Manufacturer URL	<a href="http://www.skf.com">http://www.skf.com</a>
Manufacturer Item Number	61806-2RS1
Weight / LBS	0.06
Outer Race Width	0.276 Inch   7 Millimeter
Outside Diameter	1.654 Inch   42 Millimeter
Bore	1.181 Inch   30 Millimeter
bore diameter:	30 mm



## China abec 5 Bearing Supplier

static load capacity:	2.9 kN
outside diameter:	42 mm
precision rating:	Not Rated
overall width:	7 mm
finish/coating:	Uncoated
bore type:	Round
cage material:	Steel
closure type:	Double Sealed
outer ring width:	7 mm
row type & fill slot:	Single Row Non-Fill Slot
fillet radius:	0.3 mm
internal clearance:	C0
maximum rpm:	9500 RPM
operating temperature range:	-40 to +210 ° F
series:	61
dynamic load capacity:	4.49 kN
$D_2$	39.4 mm
$r_{1,2}$ min.	0.6 mm
$d_a$ min.	32 mm
$d_a$ max.	32.5 mm
$D_a$ max.	40 mm
$r_a$ max.	0.3 mm
Basic dynamic load rating C	4.1 kN
Basic static load rating $C_0$	2.9 kN
Fatigue load limit $P_u$	0.146 kN
Calculation factor $k_r$	0.015
Calculation factor $f_0$	13.9
Mass bearing	0.025 kg